

luxury does not mean just expensive materials,
luxury is above all comprehensive customer care...

Make use of our extensive knowledge and long-term experience with adjusting layouts. We have deep knowledge of the layout of every flat – and thus of its possibilities too.

We take pride in personal approach and flexibility and meet the ideas and requests of our clients on elaborating the draft of needy client changes. We help with the choice of construction and craft work, keep an eye on the quality of execution and push your interests until the final execution of the whole interior. Sufficiently in advance, you can design and have manufactured any built-in furniture or accessory to suit your needs, taste and ideas.

We are well informed about the latest trends in interior design. We use proven contractors that utilize the most advanced technological procedures for subsequent execution, always to your full satisfaction and keeping in mind your budget.



**ON BOOKING ANY FLAT OR COMMERCIAL
UNIT OF THE SATPO RESIDENTIAL OFFER
WE WILL PROVIDE YOU WITH
FIRST THREE HOURS FOR FREE
FOR THE PURPOSE OF CONSULTING
AN ARCHITECT AND EXECUTING DESIGNS.**

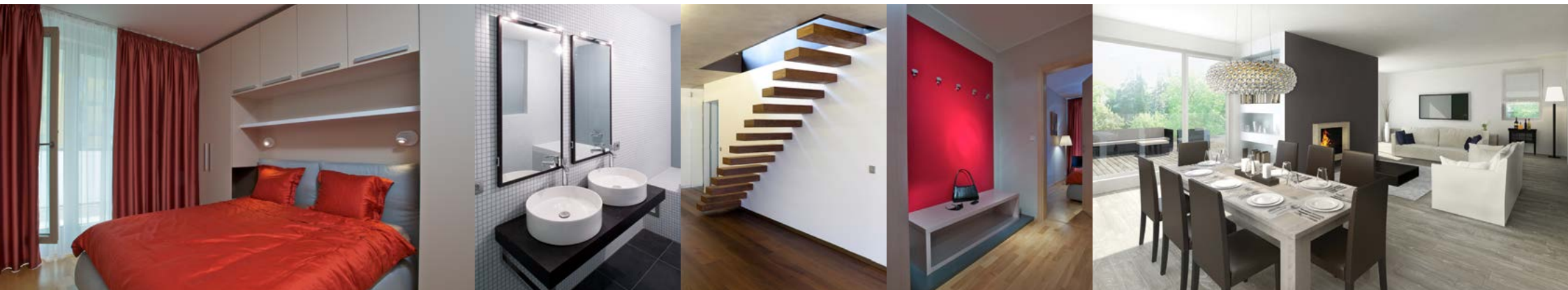

ARCHITECTONIC SERVICES

- during the first consulting session with you we will assess whether the flat unit chosen meets your needs and the requirements of superior living
- we will answer various questions of yours, such as: "Will the furniture I need, e.g. a dining table for six persons, a desk, an upright piano, a large bed or a sufficient number of wardrobes fit into the flat? Is the kitchen spacious enough for an American refrigerator? Is it possible to add a shower or a bidet into the bathroom?"
- we will design an efficient use of space in accordance with ergonomic requirements, we will plot your requirements into an understandable plan in the form of an architectural study
- we will discuss the design elaborated and submit the final version of your new home
- we will assess and recommend the scope of necessary client changes and the need for construction modifications
- we will submit price options, which will assist you in decision-making
- we will hand over complete documentation and the valuation of the design approved for execution

INDIVIDUAL LAYOUT ADJUSTMENTS

- we will make use of our extensive experience with the execution of bespoke interiors
- we will address experienced and proven craftsmen and companies
- we will provide the valuation of the interior design
- we will keep an eye on the quality of the execution of layout adjustments
- we will push your ideas and interests until the execution of construction adjustments and final assembly of furnishings

TURNKEY INTERIOR EXECUTION

- we will recommend and, based on consultation with you, choose suitable contractors for turnkey interior execution down to the material and colour design, lighting and overall layout in order to achieve the atmosphere expected
- we will provide you with several options of the designs of furnishing with concrete interior elements by proven companies, with the possibility to take advantage of a discounted price, agreed upon with our contractual partners
- we will submit and assess price quotations submitted by contractors
- we will see to your interests until the final execution of the whole interior of your flat

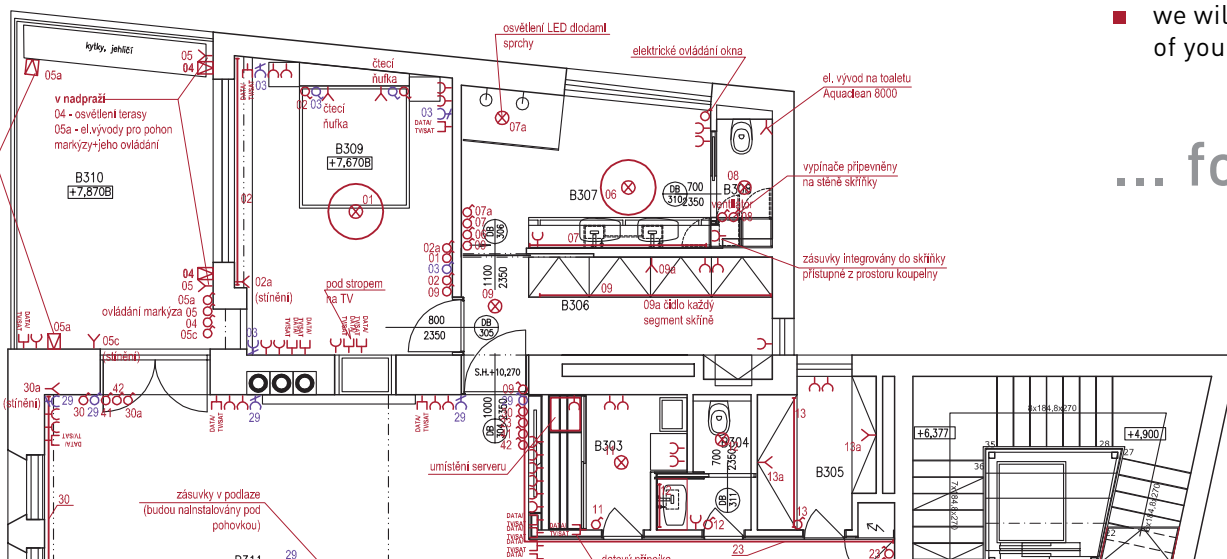

... for superior living
to your full satisfaction.